

FW4-dc



4 poles direct-current brushes rotating welders.

Protection: IP 23

Weldable electrodes: all types, included basic and cellulosic. Electronic regulation of welding current.

Supplied with autoresettable thermal breaker against overload. Equipped with Tunable Arc Force, Hot Start and Anti Stick devices.

Can also be used as alternator

Shape: IM B34 - B3/B14, IM B35

B3/B9, IM B35 - J609b, SAE 4, SAE 5

Technical characteristics of welder

Type	Code	Speed rpm	Weight kg	Welding current DC A	Strike voltage V	Welding voltage V	Duty	Required HP
FW4 250 MDC	96314170.A2	1500	80	30 250	70	21.2 30	250A 60 %	250A: 12 kW - 16Hp
FW4 250 TDC	96314170.X2	1500	80	30 250	70	21.2 30	250A 60 %	250A: 12 kW - 16Hp
FW4 300 MDC	96314170.F2	1800	80	30 300	70	21.2 32	300A 60 %	300A: 15kW - 20Hp
FW4 300 TDC	96314170.Q2	1800	80	30 300	70	21.2 32	300A 60 %	300A: 15 kW - 20Hp

Technical characteristics of alternator

Tipo Type	Codice Code	Trifase (cos =0.8) Three phase (cos =0.8)				Monofase (cos =1) Single phase (cos =1)			
		Potenza Power (S1) - kVA	Tensione Voltage V	Corrente (max S1) Current (max S1) A	Frequenza Frequency Hz	Potenza Power (S1) - kVA	Tensione Voltage V	Corrente (max S1) Current (max S1) A	Frequenza Frequency Hz
FW4 250 MDC	96314170.A2	-	-	-	-	5.0	230	21,7	50
FW4 250 TDC	96314170.X2	8	400	11.5	50	3.0	230	13,0	50
FW4 300 MDC	96314170.F2	-	-	-	-	7.0	240	29,2	60
FW4 300 TDC	96314170.Q2	10	416	13.8	60	4.0	240	16,6	60

NEW CHOPPER

ELECTRONIC TECHNOLOGY
ON FW2 400 MDC AND FW2 400 TDC

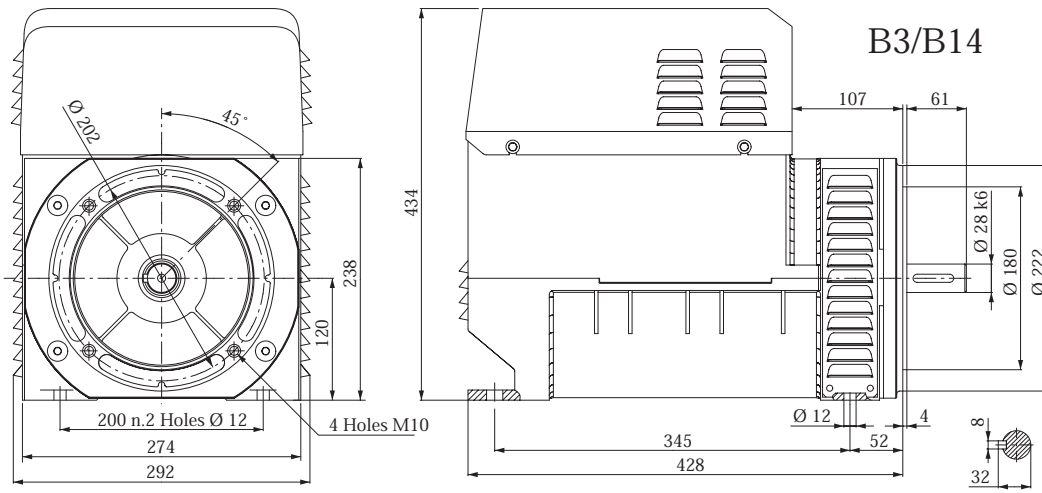

B3/B14

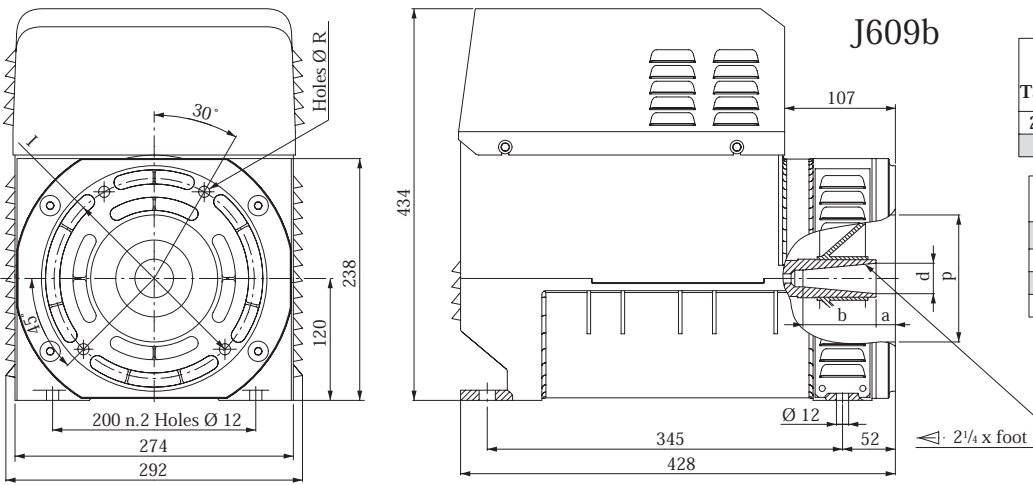

J609b

		Shaft		
Taper	d	a	b	
25.4	25.4	63.5	48	
35	30	39	72	

		Endbell		
I	p	Holes	R	
165	146.1	4	11	
197	163.6	4	11	
197	177.8	4	11	

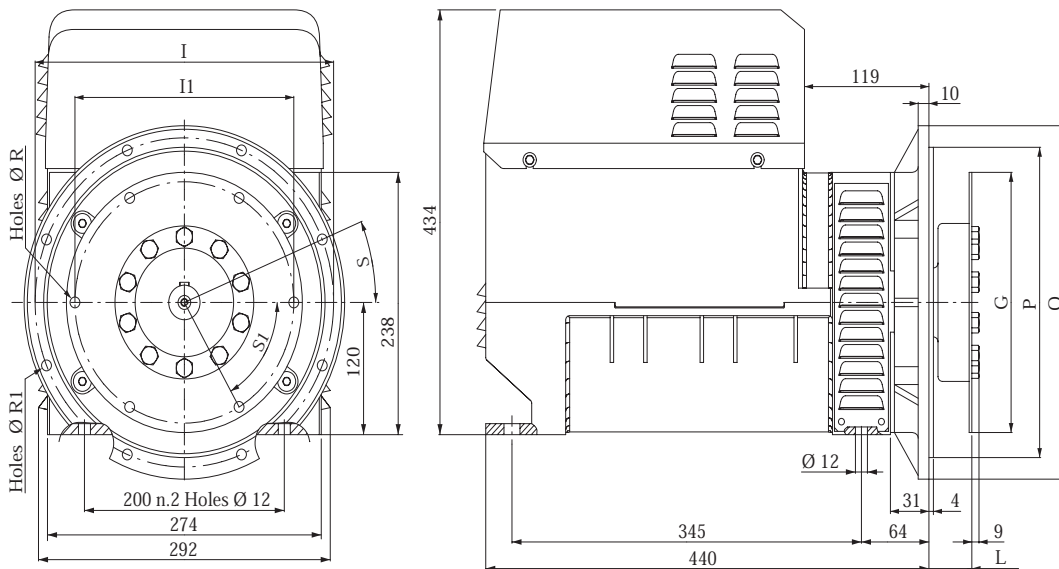

SAE

		Bell Housing				
SAE	Q	P	I	Holes	R1	S
4	405	362	381	12	11	15°
5	358	314.3	333.4	8	11	22°30'

		Disk				
SAE	L	G	I1	Holes	R	S1
6.5	30.2	215.9	200	6	9	60°
7.5	30.2	241.3	222.2	8	9	45°